

No guarantee can be given in respect of this translation
In all cases the latest German-language version of this standard shall be taken as authoritative

In case of changes this printout is not taken into account!
Besides this is a copy and only for in-house purposes of SMS Schloemann-Siemag AG. (acc. to DIN reference sheet 3)

Nachdruck, auch auszugsweise, nur mit Genehmigung des DIN Deutsches Institut für Normung e. V., Berlin, gestattet.

Translation
Technical Help to Exporters Service of BSI

Screwed Steel Pipe Fittings

Parallel Nipples, Taper Nipples

DIN
2982

Stahlfittings mit Gewinde; Rohrnippel, Rohrdoppelnippel

In the present Standard, the units used in the edition of June 1962 have been converted to the units stipulated by the legislation of 2 July 1969 regarding the "Units for Measurement", without changing the material content of the Standard.

Dimensions in mm

Parallel nipple

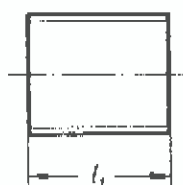

Thread according to DIN 259

Taper nipple

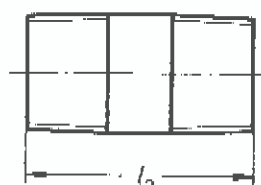

Thread according to DIN 2999 Part 1

Designation of a parallel nipple in welded pipe of DN 25 (symbol 1), black:

Parallel nipple DIN 2982 – 1

Designation of a taper nipple in seamless heavy grade tube according to DIN 2441 of DN 25 (symbol 1) and length $l_2 = 100$ mm, galvanized:

Taper nipple heavy DIN 2982 – 1 × 100 seamless galvanized

Symbol	1/8	1/4	3/8	1/2	3/4	1	1 1/4	1 1/2	2	2 1/2	3	4	5	6
Nominal size DN	6	8	10	15	20	25	32	40	50	65	80	100	125	150
Parallel nipple														
Length l_1	16	18	22	25	30	35	38	38	45	55	60	70	85	100
Taper nipple														
Length l_2	40													
	60													
	80													
	100													
	120													
	150													
	180													
	200													
	250													
	300													

For technical reasons, the sizes corresponding to these compartments are not available

Material: for parallel nipples, seamless or welded steel according to DIN 2441
for taper nipples, seamless or welded steel according to DIN 2440 or DIN 2441

Finish: regular finish black, welded
if required seamless or galvanized, state this in the standard designation

Internal pressure test with water: 50 bar

Permissible length variations see DIN 2980

Explanations on page 2

Bearbeitet: Normung

18.3.08.1



Explanations

The title of the standards DIN 2980 to DIN 2993 is "Screwed steel pipe fittings" in order to distinguish them from other types of connection.

The division into the two groups "Piping components" and "Pipe fittings" in DIN 2980 corresponds to the different areas of use.

The standards contain all the types and sizes required for the usual run of installation work. Sockets and reducing sockets have been separated. For technical reasons, piping components with parallel thread are now only standardized in the reinforced pattern. Certain overall dimensions have been slightly modified in order to secure agreement with ISO Recommendation R 49 for malleable cast iron pipe fittings, as far as this is possible from a production viewpoint.

Permissible dimension variations have been restricted for piping components and new provisions have been introduced for the position of the thread axis relative to the axis of the pipe fitting in DIN 2980.

